

# DMT80480T070\_03W

7.0 Inches, 800xRGBx480, 65K Colors, DGUS LCM

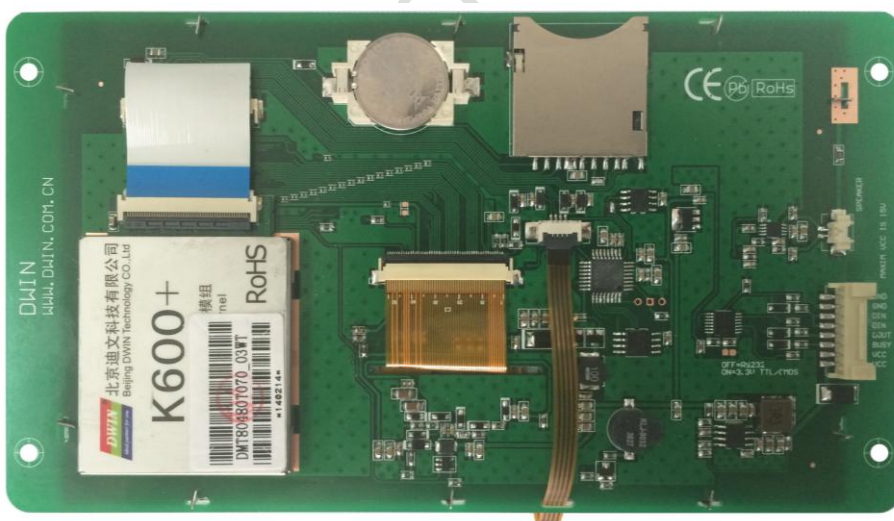

## Record of Revision

| Revise Date | Content       |
|-------------|---------------|
| 2014-02-17  | First Edition |

## ● Display

| Item               | Parameter                   | Description                   |
|--------------------|-----------------------------|-------------------------------|
| Color              | 65K (65536) colors          | 16-bit color 5R6G5B           |
| Active Area (A.A.) | 154.1mm (W) x85.9mm (H)     | 800x480                       |
| View Area (V.A.)   | 155.1mm (W) x86.9mm (H)     | 800x480                       |
| Resolution         | 800x480                     | 90° rotated display (480x800) |
| Backlight          | LED                         | -                             |
| Brightness         | 300 nit (DMT80480T070_03WN) | 64 levels adjustment          |
|                    | 250 nit (DMT80480T070_03WT) | 64 levels adjustment          |

## ● Voltage & Current

| Item                                | Conditions                | Min | Typ. | Max  | Unit |
|-------------------------------------|---------------------------|-----|------|------|------|
| Power Voltage                       |                           | 5.0 | 12.0 | 15.0 | V    |
| Operation Current                   | VCC = +12V, Backlight on  | -   | 250  | -    | mA   |
|                                     | VCC = +12V, Backlight off | -   | 120  | -    | mA   |
| Recommended power supply: 12V 1A DC |                           |     |      |      |      |

## ● Reliability Test

| Item                | Conditions           | Min | Typ. | Max | Unit |
|---------------------|----------------------|-----|------|-----|------|
| Working Temperature | 60%RH at 12V voltage | -20 | 25   | 70  | °C   |
| Storage Temperature | -                    | -30 | 25   | 85  | °C   |
| Working Humidity    | 25°C                 | 10% | 60%  | 90% | RH   |
| Protective Paint    | -                    | -   | None | -   | -    |
| Aging Test          | -                    | -   | 24   | -   | H    |

## ● Interface

| Item                       | Conditions  | Min   | Typ.   | Max     | Unit |
|----------------------------|---|-------|--------|---------|------|
| Baud Rate                  | Standard  | 1200  | 115200 | 921600  | bps  |
|                            | User define   | 1200  | -      | 1000000 | bps  |
| Output Voltage (TXD, BUSY) | Output 1, Iout = 1mA  | 3.0   | 3.2    | -       | V    |
|                            | Output 0, Iout = -1mA   | -     | 0.1    | 0.2     | V    |
| Input Voltage (RXD, I/O)   | Input 1, Iin = 1mA  | 2.0   | 3.3    | 15.0    | V    |
|                            | Input 0, Iin = -1mA   | -15.0 | 0.0    | 0.3     | V    |
| Interface                  | Mode is determined by Jumper: ON = 8N1, 3.3V TTL/CMOS; OFF = 8N1, RS232 |       |        |         |      |
| Socket                     | 8Pin_2.00mm with lock catch   |       |        |         |      |
| USB                        | None  |       |        |         |      |
| SD slot                    | Yes (SD/SDHC, FAT32 file format)  |       |        |         |      |

## ● Memory

| Item  | Parameter               | Min | Typ. | Max  | Unit |
|-------|-------------------------|-----|------|------|------|
| Flash | Space of Font           | -   | 32   | -    | MB   |
|       | Picture Storage (256MB) | -   | -    | 278  | Pcs  |
|       | Picture Storage (2GB)   | -   | -    | 2528 | Pcs  |
| RAM   | Variable Storage Space  | -   | 56   | -    | KB   |

## ● Peripherals

| Peripherals Acquired |   |
|----------------------|---|
| Peripherals          | DMT80480T070_03WN: RTC, Buzzer, 128 Segments of Audio playback<br>DMT80480T070_03WT: 4-wire resistance touchscreen, RTC, Buzzer, 128 Segments of Audio playback |

## ● Packing Capacity & Dimension

| Dimension        |   |       |                |               |
|------------------|---|-------|----------------|---------------|
| Dimension        | 190.5 (W) x 105.4 (H) x 15.6 (N) / 17.1 (T)mm |       |                |               |
| Net Weight       | 260g (DMT80480T070_03WN)                      |       |                |               |
|                  | 310g (DMT80480T070_03WT)                      |       |                |               |
| Packing Capacity |   |       |                |               |
| Model            | Size  | Layer | Quantity/Layer | Quantity(Pcs) |
| Carton5          | 600mm(L)x450mm(W)x300mm(H)                    | 1     | 20             | 20            |

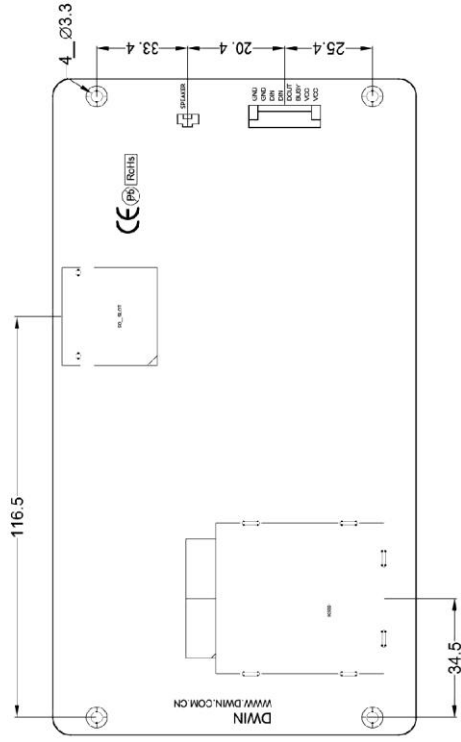
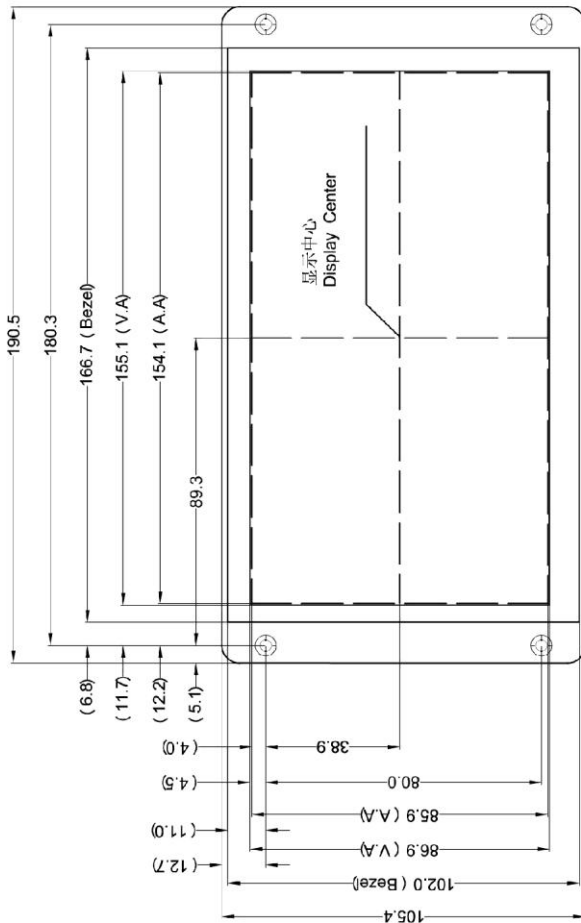

1. 尺寸定位基准为定位孔。  
Location hole is used as Drawing Reference.
2. 未标注公差为 ±0.3mm。  
General Tolerance is ±0.3mm.
3. 虚线标注为有效显示区域。  
Active Area (A.A.) is marked in dash lines.

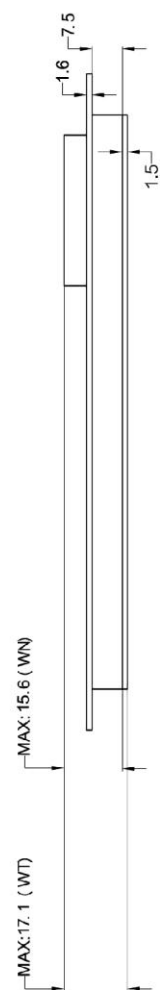

| 引脚名称 | 引脚编号 | 引脚类型 | 说明                 |
|------|------|------|--------------------|
| VCC  | 1,2  | P    | 电源输入 / Power Input |
| BUSY | 3    | -    | 未定义 / Not Defined  |
| DOUT | 4    | OUT  | 迪文屏串口输出 / DOUT     |
| DIN  | 5,6  | IN   | 迪文屏串口输入 / DIN      |
| GND  | 7,8  | P    | 公共地 / GND          |

|    |                  |    |         |
|----|------------------|----|---------|
| 型号 | DMT80480T070_03W |    |         |
| 图纸 | A4               | 绘图 | DWIN 日期 |
| 比例 | 1:1              | 审核 | 日期      |
| 单位 | mm               | 批准 | 日期      |

**DWIN**  
北京迪文科技有限公司  
Beijing DWIN Technology Co., Ltd.